

Classic Log Homes, Inc

845 Hwy 73 South
 Wisconsin Rapids, WI 5449
 Office / Cell: 715-887-2550
 Fax: 440-815-2550
 Email: jeff@classicloghomes.biz
 Web: www.classicloghomes.biz

This plan provided by © Great House Designs

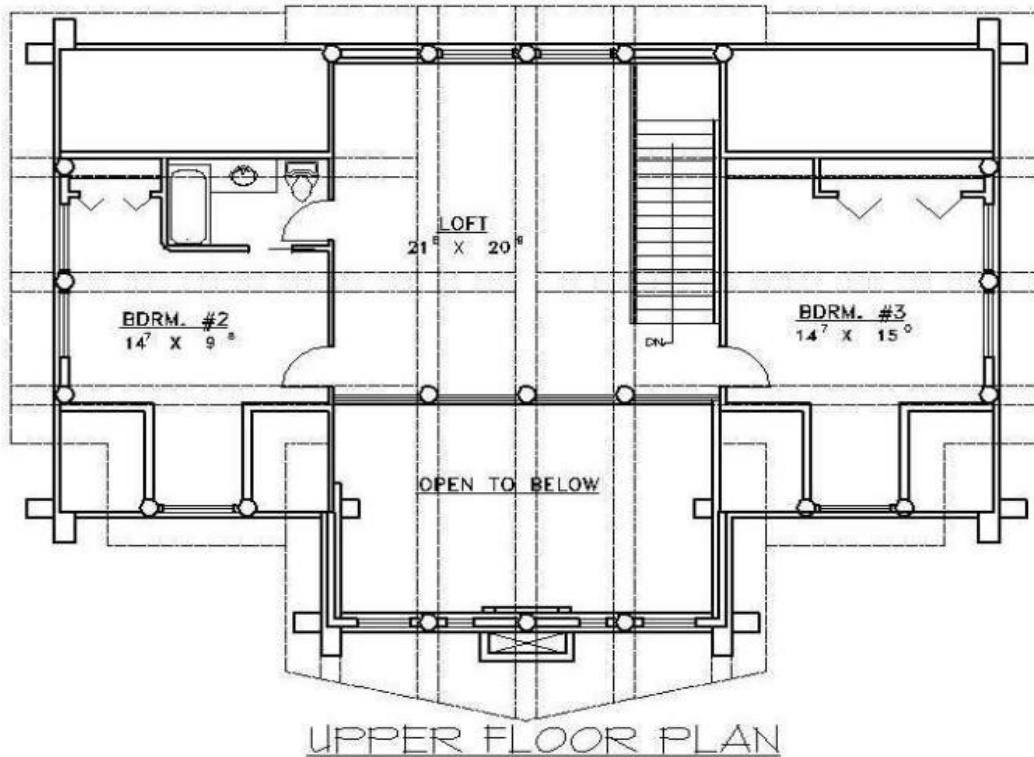
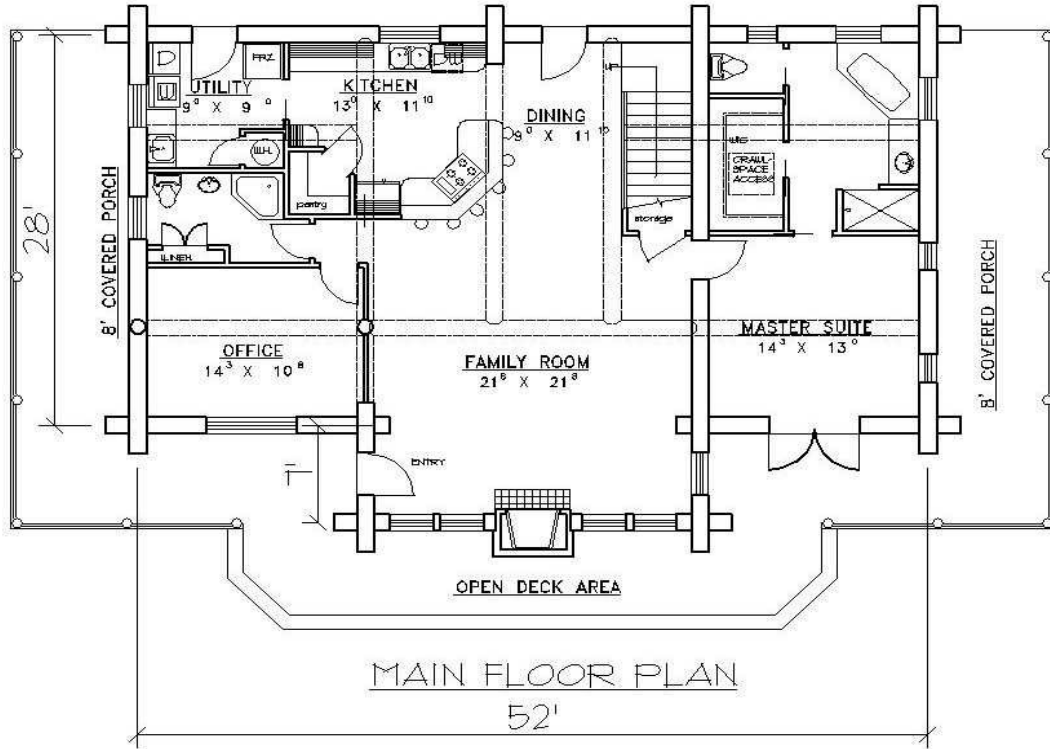

FINISHED

TOTAL MAIN FLOOR:	1637
Solarium/Sun Room:	
TOTAL UPPER FLOOR:	1046
Bonus Room:	
THIRD FLOOR:	
LOWER FLOOR/BASEMENT:	

TOTAL FINISHED LIVING AREA:	2683
TOTAL LIVING AREA W/ BRICK:	
TOTAL AREA:	2683

NUMBER OF BEDROOMS:	3
(included rooms that could function as bedrooms in accordance with codes, as well as those marked specifically "Bedroom")	

NUMBER OF BATHROOMS:	3
-----------------------------	---

EXTERIOR WALL FRAMING (2x4, 2x6, concrete block,etc)	12 inch	Notched Log Home
WIDTH	67'-10"	
DEPTH	44'-8"	
HEIGHT OF HOME (from finished main floor line to ridge peak)	28'- 9"	
MAIN ROOF PITCH	12 in. 12	
ROOF CONSTRUCTION (stick or truss)	stick	
ROOF FRAMING (2x4, 2x6)		
CEILING HEIGHTS (of ceilings that are other than the standard 8'-0")	ROOM	HEIGHT
	Main level	10'- 6"
	Upper level	11'-2"